



House & Land

Priced From Low \$400k

ABOUT THE HOUSE & LAND PACKAGE



Located in the NEWLY RELEASED Canopy's Edge LAKESIDE, all bedrooms feature built in wardrobes, with the master bedroom having a private en-suite. Incl's separate laundry, remote controlled double garage. The open plan living layout flows onto the outdoor patio with the yard backing onto a creek reserve affording a raised view overlooking the creek. (No rear neighbours!!)

PROPERTY FEATURES

- Type: House & Land
- Master bedroom with en-suite
- Outdoor Entertaining Area
- No rear neighbours
- Walk in laundry
- Open plan living
- 6.6kw Solar Power
- 32 Amp power outlet in garage for electric cars
- Landscaping

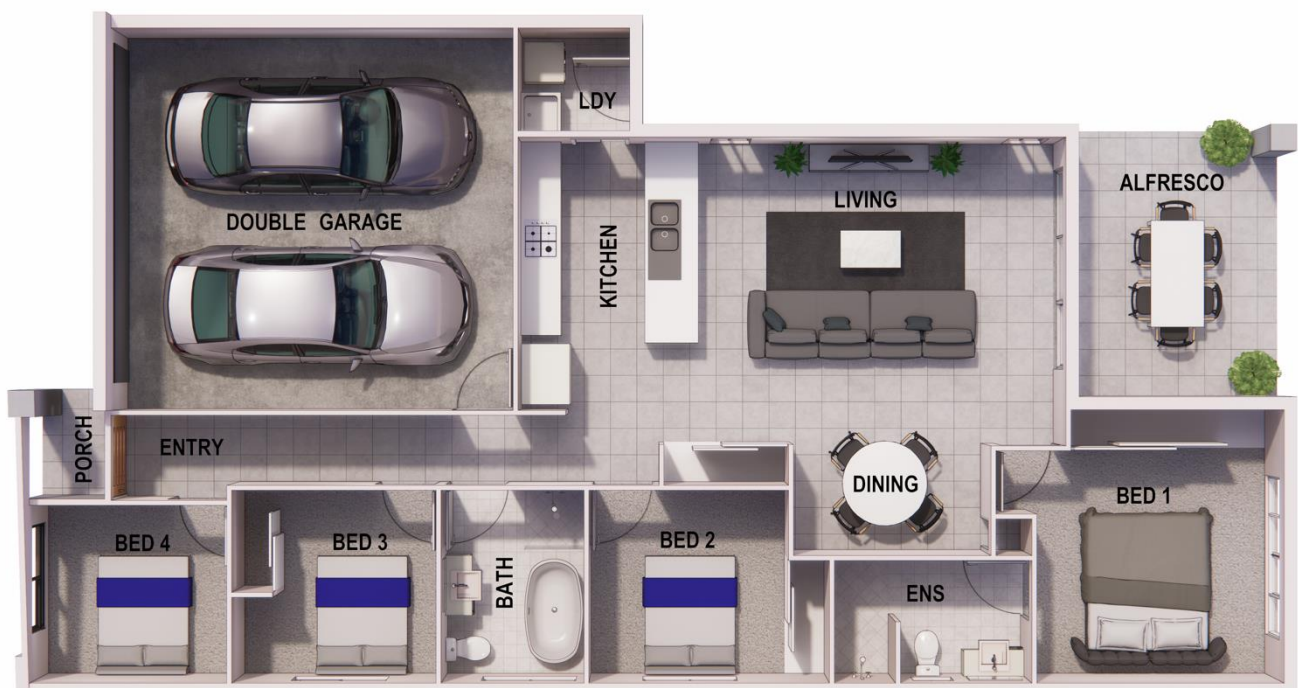

Canopy's Edge, Sales and Information Centre, 2 Ashwood Circuit, Smithfield Qld 4878

(07) 4038 3888 (07) 4038 3777 www.canopysedge.com.au sales@canopysedge.com.au