

2/26 Eagleview Place



ABOUT THE PROPERTY

The Villa is located at the top of Smithfield's most prestigious sub-division Canopy's Edge. Built by Boutique Constructions, the villa features two separate living areas/ kitchens and two bedrooms on each level which have the option to be individually accessed. This allows the villa to be suitable for an extended family or for an investment – "Host My Home" estimate a price range of between \$180 and \$230 per night via Airbnb. [Depending on demand]

The ground floor features a carport large enough for 3-4 vehicles as well as sufficient space for a swimming pool.

The first floor of the villa features a large patio/deck area which can be sectioned off to be accessed from each living area.

4 🛏️, 2 🚿, 3-4 🚗

LAND: 442.99m² VILLA: 379.46m²
(balance is common area)

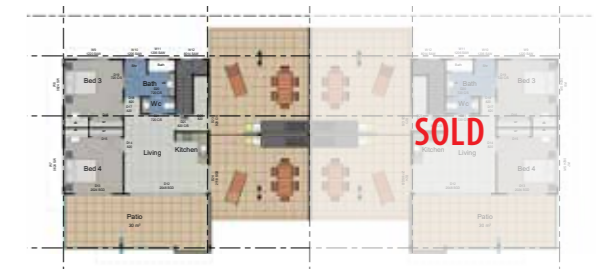

UPPER LEVEL



GROUND FLOOR

PROPERTY FEATURES

TYPE: 2 Storey Villa

- Telecommunications - Underground Fibre Optic Cable Technology for high speed Internet, telephone and Free to Air TV. All major telecommunication providers are available.
- Outdoor & Rooftop Entertaining Area
- Fully Landscaped



...where tranquil living awaits you!